



Bear Management Annual Report
Montana Fish, Wildlife & Parks
Red Lodge Office- Region 5



Figure 1. A sow grizzly and her cubs linger near a trap.

Prepared by: Daniel McHugh, MFWP Region 5 Bear Specialist



Table of Contents

Acknowledgements.....	3
Introduction.....	3
Goals and Objective.....	6
Information, Education, and Outreach.....	6
Prevention.....	7
Conflict Response.....	9
Captures and Mortalities.....	13
Conclusion.....	14



Figure 2. Multiple grizzlies share a carcass on the Beartooth Front.



Acknowledgements

Bear management in Montana Fish, Wildlife & Parks' (MFWP) Region 5 is a joint effort between the regional bear specialist and supervisors, area biologists, area wardens, and the regional communication and education (comm. ed.) coordinator. Due to the disproportionate level of conflict and attention needed in the Red Lodge area over the course of 2023, a big thanks is owed to the team tasked with managing the needs specific to Red Lodge: regional wildlife manager Matt Ladd, regional wildlife biologist Shawn Stewart, local wardens Matt Heaton and Frank Blundetto, comm. ed. coordinator Chrissy Webb, and City of Red Lodge planning director Courtney Long. Despite their many other duties, this group rallied to add vital time, effort, and area knowledge to help construct a viable bear management program for the area now and into the future.

Additional thanks are owed to the many people and organizations throughout the region for their support to the program: MFWP Regional Supervisor Mike Ruggles; regional warden captain Randy Hutzenbiler, wardens Paul Luepke and Derek Fagone, and the entire warden staff; MFWP area biologist Justin Paugh; MFWP pilot Neil Cadwell; MFWP R5 wildlife technician Dana Harty; MFWP bear specialists Jeremiah Smith, Chad White, and Wesley Sarmento; USDA Wildlife Services specialists Finny Helske, Doug Eckberg, and biologist Zach May; US Fish and Wildlife Service conflict and recovery coordinators Ben Jimenez and Hilary Cooley as well as conflict specialist Amber Kornak; US Forest Service district ranger and acting district ranger Ken Coffin and Amy Haas, along with the rest of the Beartooth Ranger District team; the Interagency Grizzly Bear Study Team including Matthew Gould, Bryn Karabench, and Chad Dickinson.

Finally, a big thanks to American Bear Foundation and Montana Outdoor Legacy Foundation for their efforts to help the region with funding for conflict prevention through bear resistant trash cans. Primary funding for bear management in the region was provided by Montana Fish, Wildlife & Parks.

Introduction

Both black bears (*Ursus americanus*) and grizzly bears (*Ursus arctos*) are present in MFWP Region 5 (R5). Black bears can be found throughout the region, though densities are higher in the mountainous, timbered western portion of the region. Grizzly bears, on the other hand, are believed to occupy only the western part of the region in the Beartooth Mountains within the Greater Yellowstone Ecosystem (GYE). Black bear management in the state is shared by MFWP and, in cases of livestock depredation, USDA Wildlife Services (WS). Grizzly bears are still listed as threatened under the Endangered Species Act (ESA), therefore ultimate management responsibility belongs to the US Fish and Wildlife Service (USFWS) with on the ground recommendations and technical assistance from MFWP and WS.

MFWP R5 has undergone an evolution in how bears are managed as bear conflicts have become more numerous over the last decade-plus. In 2022, R5 secured funding from MFWP for



a full-time bear specialist. Prior to 2022, Kylie Kembel served as the regional grizzly bear technician based out of Red Lodge. At the time, her primary responsibility was to meet the growing need for grizzly bear conflict response in the region. The year 2023 served as the first complete year the region had funding for a specialist. The move to fund a full-time specialist allows the region to build a more comprehensive and modernized bear management program for both species, much like other regions in the state with similar conflict demands (Regions 1, 2, 3, and 4).

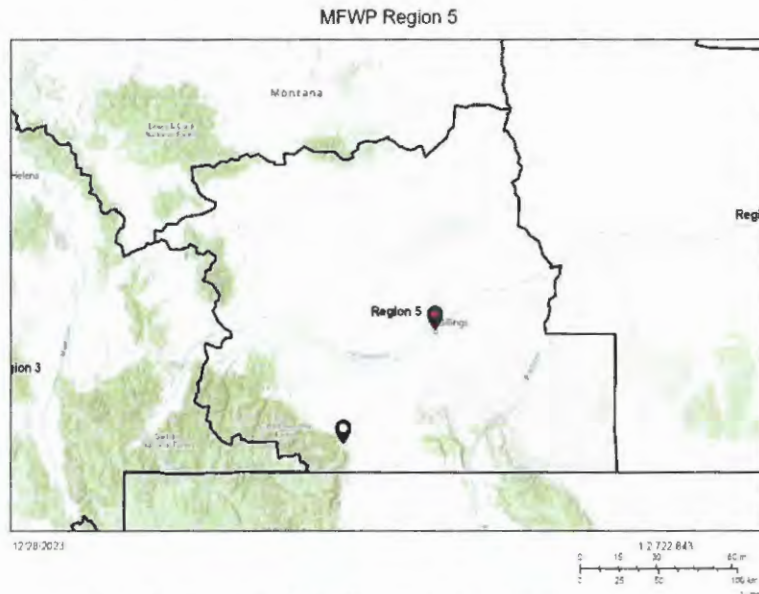

Figure 3. Montana Fish, Wildlife & Parks Region 5 with Regional Headquarters in Billings and bear management office in Red Lodge marked.

Because the R5 bear management program is relatively new, investments from MFWP were vital in 2023 to modernize equipment and increase program capacity. The purchasing of a drone and a new ground trap were invaluable investments in 2023. An Autel EVO II thermal imaging drone was purchased by the department at the beginning of the fiscal year and obtained midway through the season. It will be useful in hazing and locating bears safely from a distance and invaluable in wildlife human attack response efforts. A grizzly bear cub ground trap, which can also be used for smaller black bears, was purchased and built midway through the season as well. The need for such a trap was identified in multiple urban black bear conflict situations where a trailer mounted trap could not safely be deployed or was ineffective. The R5 team is grateful for MFWP's investment in these essential items.

The R5 bear management team saw many of the same challenges as other regions across the state in 2023: increases in the human/wildlife interface from development and urbanization, increases in distribution and potentially number of both bear species and a general trend toward increasing conflicts. While some areas in the state saw fewer conflicts than normal in 2023, R5



saw an increase in black bear conflicts from average years in part due to poor natural food production.

For the second year in a row, grizzly bear conflicts remained lower than previous years and were primarily confined to the area in and surrounding Red Lodge. Many of the grizzly bear conflicts in 2023 occurred on National Forest land. Black bear conflicts, however, were widespread and occurred primarily on private land where black bear densities and conflicts have historically been low relative to 2022 and 2023. For this reason, timely responses and robust prevention efforts are of the utmost importance presently and moving forward as both human development and distribution of bears expand.

Grizzly bear expansion:

In 2023, a lone subadult grizzly was confirmed on private land in the Pryor Mountains south of Billings, MT. While numerous reports of grizzlies in the Pryor's have been fielded over the years, this was the first occurrence confirmed by an agency official since before the listing of grizzlies under the ESA in 1975. The Pryor Mountains are made up of private land, National Forest, Bureau of Land Management, National Monument, and the Crow Indian Reservation to the north. The bear was not involved with any conflicts or complaints, and the area was monitored for the entirety of the season.

The Pryor Mountain bear, coupled with a confirmed grizzly along the Shields River in the Crazy Mountains, further illustrate the expansion of grizzlies on the Montana side of the GYE. The probability of GYE bears moving eastward and northward in the coming years is high, requiring an increased level of attention to be paid to communities that may be impacted by their presence.



Figure 4. Grizzly bear “May Be Present” map, courtesy of USFWS.



Goals and Objectives

The pillars of bear management in Montana, regardless of region, are conflict prevention, education and outreach, and conflict response. While R5 has had skilled and competent staff to meet some bear management needs over the years, the regional bear management program is in its infancy and is in need of further development. The overarching goal for the 2023 management year was to develop a lasting framework for bear management in the region for both black and grizzly bears based on these three pillars. The objectives to meet this goal were as follows:

- assess area conflict prevention needs and work with interagency and community groups to develop a culture of prevention (electric fencing, awareness of potential attractants, bear safety, etc.).
- identify areas of increasing bear conflict, bear expansion, and lack of adequate attention from the agency; provide bear education in cooperation with MFWP staff and agency partners. .
- assess equipment needs and purchase cutting edge equipment utilized by the rest of the state; build community relationships by being highly responsive to conflicts and complaints.

Information, Education, & Outreach

R5 was limited to only one full-time employee responsible for bear conflicts in 2023, Daniel McHugh (authoring this note). Therefore, IEO efforts were somewhat more limited than may be afforded in other regions. A total of 14 education events were held by MFWP and partnering agencies in 2023 throughout the region:

- Hunter education in Red Lodge
- BLM staff bear safety training in Pompey's Pillar
- Big Timber town hall featuring MFWP, WS, and USFWS
- Americorps volunteer bear safety in Red Lodge
- Red Lodge Summer Fest bear booth
- Electric fencing workshop in Red Lodge
- Red Lodge town hall
- Bear safety presentation with Lat 45 group
- Yellowstone County Safe Kids event
- Bear Aware Month Region 5 kickoff event
- Winnett Conservation Day
- Bear Aware Month Region 5 event
- Audubon Center bear aware day
- Billings area homeschoolers bear safety presentation



Additionally, communication, education, and outreach coordinator Chrissy Webb worked closely with regional and statewide MFWP staff, as well as multiple partner agencies to handle press releases, news interviews, and social media posts. Her efforts were vital to communicating information promptly and accurately in addition to organizing robust attendance at education events.



Figure 5. Sergeant Courtney Tyree speaks with the public about bears (left), and an electric fence constructed jointly by Wildlife Services, MFWP staff, and homeowners (right).

Prevention

The region has seen a recent uptick in hobby farm operations (chickens and bees in particular), demanding a broader need for electric fencing to prevent bear conflicts. The R5 bear management team made huge strides in getting landowners situated with electric fencing in 2023 by offering labor, lending materials, and helping with small cost items such as insulators and poly-wire fencing when possible. A free electric fence workshop was held in August in Red Lodge by MFWP, USFWS, and USDA Wildlife Services in an effort to increase the use of this effective tool in the community. Additionally, USDA Wildlife Services played a major role in outfitting landowners with equipment utilizing their cost share program.

Carcass removal is a major part of any successful bear management program. Livestock carcass removal decreases high concentrations of bears near home sites and areas of high conflict potential. The state assists or directly removes livestock carcasses to one degree or another in regions 2, 3, and 4. While R5 has neither the resources nor the demand for robust deadstock removal programs presently, it will undoubtedly be a need going forward. As of now, removal of roadkill and game animal carcasses takes highest priority in the area as dead deer, elk, and moose draw bears near highways, homes/cabins, and areas frequented by people.

Natural and domestic fruits were an abundant source of complaints in 2023. MFWP responded by building electric fences, removing fruit trees, or recommending homeowners remove fruit. R5 does not remove fruit in most cases and puts that responsibility on property owners. Unfortunately, multiple calls were fielded in 2023 where bears were initially attracted by fruit and came into conflict as a result. Finding creative ways to remedy fruit related proximity complaints will be paramount moving forward.



Finally, trash is the primary obstacle in R5 as both black and grizzly bears were involved with multiple conflicts involving garbage. As illustrated in Figure 6, trash and anthropogenic foods were major drivers of more serious conflicts such as property damage, home or vehicle entry, and aggressive encounters in 2023 (see Conflicts section for more information). Republic Services has been instrumental in the distribution of bear resistant trash cans in various R5 communities at a discounted cost upon request from MFWP or property owners. Additionally, the City of Red Lodge has a city ordinance requiring bear resistant bins in city limits. However, MFWP responded to multiple complaints about bear resistant bins not functioning properly in 2023 and worked closely with Republic Services to get those bins fixed or replaced. MFWP is working on future solutions in cases where individuals are not serviced by Republic Services and not have current access to bear resistant trash cans

All said, MFWP put forth the following preventative efforts in 2023:

- involved with the construction of 9 electric fences
- removed 8 carcasses (2 moose, 4 deer, and 2 black bears)
- distributed 3 bear resistant trash cans and worked with Republic Services to distribute roughly 20 others
- worked with landowners to remove 2 apple trees

Resulting from unsecured attractants



Figure 6. Serious conflicts associated with bears receiving unsecured food sources in 2023 (not including fruit trees).



nature. As grizzly bears expand their range, the teamwork dynamic to bear management in the region will become even more valuable.

Grizzly bears:

Grizzly bear conflicts were relatively low for the region for the second year in a row. Multiple factors may contribute to this phenomenon including heavy spring snows producing considerable green-up and excesses of winter kill, habitat changes due to the 2021 Robertson Draw fire near Red Lodge, and removal of problem grizzlies in subsequent years. Whatever the case, there were 7 total conflicts in R5 in 2023, which is roughly equivalent to 2022. Notably, R5 saw an average of 16 depredations/year between 2011 and 2021 before the fire. Since the fire, there have been no confirmed depredations. The primary sources of conflict have been encounters with people, trash/unnatural foods, and proximity to homes.

One grizzly bear in the region caused a number of the conflicts in 2023. Grizzly bear 896, a sow collared first for research, then for conflict in Wyoming, has spent all of the last 5 years in and around Red Lodge since being relocated to Fox Creek along the Montana/Wyoming border by Wyoming Game and Fish. Over the years, she has become severely habituated to human structures and developed areas, particularly with young. When her collar fell off in August 2023, MFWP relied on sparse public reporting to track her movement. Were she to have been accounted for through radio tracking, conflicts for home proximity would have been near daily from late August to late October.

The agency has made multiple efforts to trap and remove grizzly bear 896 as she has been involved with multiple conflicts including lingering in campgrounds, close encounters with people, and two trash events. Trapping efforts have been unsuccessful. Due to her proximity to people, trapping her with a single culvert presents a high risk to public safety, while trapping with multiple trailer mounted culverts has both risks and low odds of success. R5 has been unsuccessful in efforts to secure funding for a family grizzly bear trap in the last three years. MFWP R4 staff out of Choteau lent their family trap to the R5 team, aiding in a brief trapping effort in 2023. Bear 896 will continue to pose a human safety risk into the future.

Two Forest Service recreation areas were closed in 2023 due to grizzly bears lingering: Greenough Lake in May, and Sheridan/Rattin Campgrounds in July. MFWP coordinated with the Forest Service on these site closures. At Greenough, a subadult bear bluff charged an individual approaching it with a camera at close range. MFWP monitored the area and found the bear to be lingering for multiple days eating natural foods. At Sheridan/Rattin, known bear 896 approached an MFWP employee and campers with her cubs. The campsites were closed as she lingered in the area for nearly a week along Rock Creek.



Grizzly Conflicts by Type

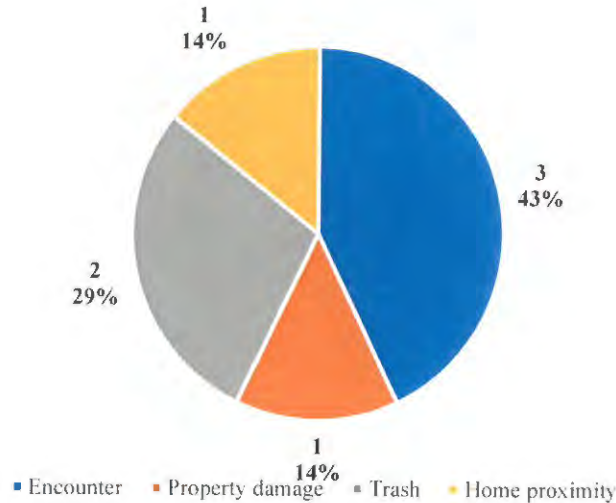

Figure 9. Home proximity includes lingering near a home or occupied structure. Unnatural food includes attainment of anthropogenic food sources. Encounters include coming into close contact with a bear showing potentially threatening behavior. Property damage includes damage to property such as buildings, vehicles, equipment, etc. Trash includes human waste/debris either properly secured or not.

Black bears:

There were 98 black bear conflicts in R5 during 2023. The conflict severity ranged from bears lingering on porches for bird feeders to breaking into occupied homes. By far the most numerous conflicts were black bears getting unsecured, and at times secured, trash. However, the majority of trash conflicts are not charted in the figure below. It is likely there were multiple black bear trash conflicts every night in Red Lodge from late-June to mid-October, rendering trash conflicts in town too numerous to count. MFWP *did not track* conflicts in city limits involving a bear attaining trash unless a physical response to an active bear was required. If these conflicts were to be counted, the black bear conflict number would likely have been hundreds more in 2023. As stated in Figure 6, there was a significant link with trash and more serious conflict events.

Aside from trash, upticks in small livestock depredation, namely chickens and bees, were higher in 2023 than years past. Anecdotally, many of the calls responded to by staff were first year hobby farmers. We expect conflicts of this nature to continue going forward. Once again, it is worth noting that short of removing the hobby farm, electric fencing is the only way to ensure reduction in conflicts. While it was primarily black bears involved with such conflicts in 2023,



nearly all of the conflicts occurred in areas occupied by both species. Finding creative and effective ways to suit homeowners with electric fencing will be paramount into the future.

Lastly, there were a significant number of serious conflicts (home break-ins, defensive shootings, aggressive encounters) in 2023 that resulted from high levels of habituation and food conditioning. A couple of these included a black bear shot in a living room in Luther, a black bear shot after fighting with dogs near Nye, and multiple instances of black bears breaking into vehicles and climbing into windows. Late or no ripening of natural fruits and a very poor whitebark pine (*Pinus albicaulis*) nut crop may have played a role, but it will be worth monitoring conflicts of this type going forward to better understand the links between conflict severity and delayed or poor natural food production.

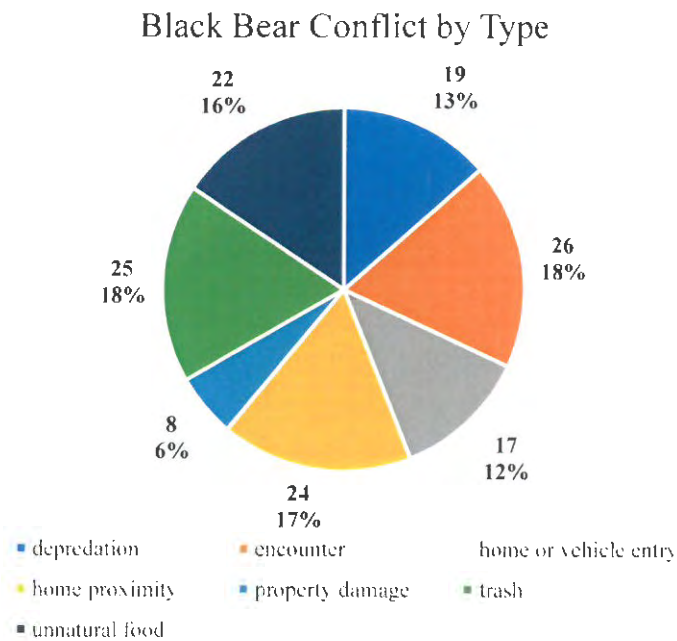

Figure 10. Depredations include attempted to or successfully killing either pets or livestock. Home proximity includes lingering near a home or occupied structure. Unnatural food includes attainment of anthropogenic food sources. Encounters include coming into close contact with a bear showing potentially threatening behavior. Property damage includes damage to property such as buildings, vehicles, equipment, etc. Home or vehicle entry includes attempted or successful entry of a home, a garage, or a vehicle. Trash includes human waste/debris either properly secured or not.



Captures and Mortalities

Trapping is a tool used sparingly in R5 due to minimal relocation options and the precedent that the public is responsible for proper attractant storage. The Pickett Pin area along the Beartooth Front is the only Commission-approved grizzly bear relocation site in the region. Bears are trapped in the following general scenarios:

- high likelihood of being a human safety risk (e.g., aggressive behavior, predatory behavior, entering structures, damaging property)
- high likelihood of repeating conflict behavior
- lingering even after attractants have been removed
- attractants can't be reasonably removed before there is a conflict

R5 staff will exhaust every other option available before trapping if there is no immediate human safety risk.

Grizzly bears:

While there were conflicts in R5 in 2023, many occurred as a result of natural bear behavior that could be solved with preventative measures such as site closures. There was only one grizzly bear capture attempt in 2023 for bear 896 and her cubs which was unsuccessful. Additionally, there were no mortalities in 2023.

- 1 trap set
- 0 captures
- 0 mortalities

All grizzly bear captures and removals are in conjunction with the USFWS per the ESA as grizzly bears are listed as threatened.

Black bears:

Due to the high number and severity of black bear conflicts in 2023, the R5 management team was forced to trap at a higher rate than is normal for the region.

- 29 traps set
- 10 captures
- 4 relocations (incidental captures)
- 6 euthanized
- 2 free shot by MFWP personnel
- ~9 shot in by public in defense of self or livestock or by another agency
- 1 incidental capture by USDA WS, marked and released by MFWP



Figure 11. MFWP bear specialist Daniel McHugh puts anesthetized black bear in culvert trap for release.

Conclusion

The R5 management year encountered many of the same challenges as other areas in Montana: increased human/wildlife interface, influx of tourism, and increases of individuals moving to the area without experience living with bears. Challenges of this sort emphasize the need for modern tools in bear management. R5 took a step in the right direction to achieve this:

Electric fencing: Through the electric fencing workshop, spreading electric fence knowledge when interacting with the public, and erecting multiple fences, the R5 team widely pushed electric fencing. While it should always be the responsibility of landowners to protect attractants, there is limited flexibility for staff to aid in this regard. Moving forward, MFWP and interagency staff will continue to host workshops. Furthermore, increasing the R5 bear budget to that of other areas in the state with high conflict needs will be invaluable.

Traps: Traps were a limitation in R5 during parts of 2023. As stated in the “Conflicts” section of this document, obtaining a grizzly bear family trap will be a major contributor to public safety going forward. In the meantime, we were able to construct a cub/yearling grizzly bear ground trap in 2023, thanks to MFWP base funding, that will be useful for resolving conflicts of both species.

Trash: As noted in previous sections, trash conflicts were high in the region. The R5 team is working to remedy this problem in a couple of ways: increased enforcement of trash violations, creating easier pathways to bear resistant trash cans, broadening community awareness, and removal of habituated bears. In an ideal world, meeting preventative objectives prior to removing bears will be vital to ensure future bears don’t fall into the same level of



habitation. In Red Lodge, where the majority of trash conflicts occur, 2 written and 12 verbal warnings were issued by MFWP. Additionally, 31 warning letters were issued by the City of Red Lodge resulting from reports by MFWP staff or the public. These warnings will likely increase in 2024. Going forward, with the help of Montana Outdoor Legacy Foundation and American Bear Foundation, MFWP aims to create a bear resistant trash can distribution program for areas not serviced by Republic Services.

Community engagement: Finally, R5 staff is working on the formation of non-MFWP run groups to help with bear conflict prevention. First, we aim to build on the current framework in Red Lodge to create a Bear Smart Community. In Bear Smart Communities, community members have an increased responsibility in reducing conflicts, rather than relying solely on management agencies such as MFWP. . Ultimately, Bear Smart programs reduce conflicts, lethal removals, and public safety concerns. Additionally, MFWP staff are working on building a community run fruit gleaning group in the Red Lodge area to mitigate conflicts incurred by residential fruit operations. Both of these programs will substantially decrease bear conflicts and staff hours needed to sufficiently manage them, and will increase resident engagement and responsibility

Overall, the R5 bear management program saw significant growth and had successes in multiple aspects of management in 2023. As bear populations and range expand, R5 staff will build on these successes and continue to meet our management goals going into 2024.

Ordinance No. 968

AN ORDINANCE OF THE CITY COUNCIL OF THE CITY OF RED LODGE, MONTANA TO SET THE PROCESS IN WHICH FEES ARE COLLECTED FOR SOLID WASTE SERVICES.

WHEREAS, the City and Republic Services, Inc. (hereinafter the "Contractor") entered into a Municipal Contract (For Residential and Municipal Facilities), approved by the City Council on June 9, 2020 (hereinafter the "Contract"); and

WHEREAS, the City and the Contractor entered into the Contract valid for a five year term ending June 30, 2025; and

WHEREAS, the Solid Waste Fees in effect at the present are adequate to provide revenue to defray the cost of the City's Solid Waste contract; and

WHEREAS, the Solid Waste Fees is currently collected through a utility assessment on the Citizen's yearly taxes; and

WHEREAS, the audit completed for FY2022-2023 identified a budget short-fall based on the manner in which fees are currently being collected; and

WHEREAS, the current budgetary requirements, with respect to the operation of the City's Solid Waste program, require fees for Solid Waste services be collected in the month services are rendered; and

WHEREAS, the City is desirous to set the process in which Solid Waste fees are collected; and

NOW THEREFORE BE IT RESOLVED by the City Council of the City of Red Lodge, Montana:

1. The City of Red Lodge shall not, and is not, increasing any rates for the payment of Solid Waste fee, not already approved or provided for; and
2. The City of Red Lodge shall modify the process in which said fees are collected by removing the utility assessment from individuals' taxes, already in existence, and placing said payment for Solid Waste onto the monthly utility bill; and
3. The City of Red Lodge hereby resolves to collect the already approved Solid Waste fees by billing residents monthly, on the monthly utility bill, in the month in which the services are rendered.

Effective Date of Ordinance

This Ordinance shall be effective 30-days after approval of second reading by the City Council of the City of Red Lodge, Montana.

BE IT ORDAINED BY MEMBERS OF THE CITY OF RED LODGE:

PASSED AND APPROVED on the first reading by a majority of the members present of the City Council of the City of Red Lodge on the 26th day of March, 2024.

PASSED AND APPROVED on the second reading by a majority of the members present of the City Council of the City of Red Lodge on the 9th day of April, 2024.

City of Red Lodge

Dave Westwood, Mayor

Attest:

Loni Hanson, City Clerk

RESOLUTION NO. 3622, 1ST AMENDMENT

**A RESOLUTION OF THE CITY COUNCIL OF THE CITY OF RED LODGE
SETTING BUSINESS REGISTRATION FEES**

Whereas, the City Council of the City of Red Lodge duly adopted Ordinance 907 on June 10, 2014 requiring all businesses located and/or operating inside the city limits to obtain a valid City Business Registration Certificate and pay a business registration fee; and,

Whereas, Ordinance 907 states that the City Council shall by resolution set the fee schedule for business registration, appropriate inspections, and related matters to be applied to all businesses that the City registers; and,

Whereas, the City Council shall by resolution classify businesses into separate categories and fees.

Now therefore be it resolved that the City Council of the City of Red Lodge establishes the following classifications of categories and rates for services relating to business registration.

BUSINESS REGISTRATION FEE SCHEDULE:

TIER I	\$100
TIER II	\$200
TIER III	\$250

CLASSIFICATIONS:

TIER I- GENERAL/SERVICES: Any Business that does not specifically fall within one of the other categories below, including, but not limited to businesses that may or may not collect resort tax, such as contractors, businesses that provide a personal service, retail business, and home-based businesses.

TIER II- TEMPORARY VENDORS: Businesses that don't operate more than 90 days within city limits. These businesses shall collect resort tax.

TIER III- LODGING AND PREPARED CONSUMABLES: Lodging and accommodation such as Hotels, Motels, Bed and Breakfast, and Short-Term rentals. Businesses that sell prepared foods, drinks, and smoke products. This includes restaurants, gas stations, grocery stores, temporary vendors that sell prepared food, bars, liquor stores, marijuana dispensaries, and smoke shops.

All fees are non-refundable.

When a business may fall into multiple applicable tiers, only the highest tiered fee shall apply- e.g., If a retail business also serves prepared food, only Tier III fee would apply.

These rates to become effective on July 1st, 2024.

PASSED by the CITY OF RED LODGE City Council and approved this ___ day of ___ 2024.

By: _____
Mayor

ATTEST By: _____
Loni Hanson, City Clerk

RESOLUTION No. 3647

**RESOLUTION OF INTENT TO AWARD THE PHASE 2 & 3 STORMWATER SYSTEM IMPROVEMENTS PROJECT
FOR THE CITY OF RED LODGE, MONTANA.**

WHEREAS, the City opened bids on March 14, 2024 and received four bids;

WHEREAS, Great West Engineering, Inc. (the Engineer) provided an award recommendation letter dated March 21, 2024 recommending award to the low bidder, Wilson Bros Construction of Montana, Inc. for all three schedules of the project.

WHEREAS, A SRF Loan will be secured to cover the construction costs of the project;

WHEREAS, the award recommendation letter includes an estimated stormwater utility rate increase based on various award options;

WHEREAS, the final user rate increase to the stormwater utility will be at or below the estimated cost presented in the award recommendation letter and will be finalized through future resolution(s).

NOW, THEREFORE, BE IT RESOLVED,

The City of Red Lodge does hereby approve the intent to award the construction contract to Wilson Bros Construction of Montana, Inc. for Schedules 1, 2, & 3 for a total construction cost of \$3,153,295.00.

PASSED AND ADOPTED by the City Council of the City of Red Lodge at a regular session thereof held on the 9th day of April 2024.

For the City of Red Lodge, Montana:

Dave Westwood, Mayor

Attest:

Loni Hanson, City Clerk

Public Works will lobby strongly that we complete all three schedules of Stormwater Phase II & III. The points being:

- The city of Red Lodge currently has a combine sewer system where stormwater and sewer flow through the same pipes. The combined flow of wastewater and stormwater can overwhelm the system. Currently, when we experience heavy rains, personnel must be on site at the sewer treatment plant to divert flows to avoid flooding the headworks building. During the flood, because of the increased flow, largely from the stormwater, the lagoon was nearly overwhelmed. Pumping wastewater out of the lagoons saved them from being destroyed. The outfall of the wastewater from pumping was untreated and a source of water pollution and public health concern. The Clean Water Act requires communities with CSOs to put controls in place to address these concerns. It is possible we could have our hand forced in this matter over time, if we do not rectify it ourselves.
- Because we are currently treating stormwater along with sewage it takes away capacity from our facility that will be needed for continued city growth. When stormwater mixes with sewer, it basically becomes sewer and must be treated accordingly. Should we exceed our capacity, we will be forced to improve our sewer treatment facilities, which would be **significantly** more costly than separating stormwater from sewer.
- Water quality. The effectiveness of treatment at lagoons is decreased by the added flow and dilution presented by the stormwater. When the stormwater is removed not only the amount of effluent we discharge into Rock Creek will be decreased, but the quality of that effluent should improve.
- The cost of waiting a year or more is high. Infrastructure project costs are always rising and have risen significantly in the past four years. Waiting will result in a higher cost project and possibly a larger rate increases down the road. Last week I listened to a presentation of the Lockwood Wastewater project. Originally, they tried to complete all the work in one project. Voters chose to break it into three phases. By the time they got to Phase III, its cost alone exceeded the entire project cost had they done it all at once years earlier. Sewer rates there are significantly higher now than what they would have they completed the whole project in one phase. **The cost of waiting is real and it will be more in coming years.**
- The low bidder on this project is Wilson Bros Construction, who completed Phase I Stormwater last year. By all accounts, they did an excellent job, worked well in the city, and know Red Lodge. If we put off work for a later date, we may not be as fortunate to have them as low bidder. A bad contractor can be more than a nuisance and present significant costs.

Estimated Rate Increase for Each Schedule:

- | | |
|------------------------------|---------|
| • Current Rate (maintenance) | \$3.40 |
| • Schedule I | \$6.37 |
| • Schedule I & II | \$11.23 |
| • Schedule I, II, & III | \$13.80 |

See what's possible.



March 21, 2024

Mike Maples and Mayor Westwood
City of Red Lodge
P.O. Box 9
Red Lodge, MT 59068

**RE: Phase 2/3 Stormwater Improvements Project – Award Recommendation
Great West Project No. 2-22109, Task Order 21**

Dear Mike and Mayor Westwood:

The bid opening for the above referenced project was held on March 14, 2024, we received four bids that met the minimum requirements to be read and one bid that did not. That bid was returned to the bidder. I have attached the certified bid tabulations for your reference. Wilson Bros Construction of Montana, Inc. is the low bidder with a bid of \$909,660 for schedule 1, a bid of \$1,442,150 for schedule 2, and a bid of \$801,485 for schedule 3. The combined total for all three schedules is \$3,153,295.

Based on review of the qualifications statement submitted with their bid, numerous projects completed with Wilson Bros Construction of Montana, Inc., and their successful completion of the Phase 1 Stormwater project, we believe they are qualified to complete this project scope.

With the bids coming in close to our engineers estimate, the estimated user rate increases associated with the SRF loan we presented on February 14, 2024 are still good estimates. It is our recommendation that the City award all three schedules of this project which would result in an estimated \$10.40/month rate increase to each lot. Should the City only elect to award phases 1 & 2 the estimated rate increase would be \$7.83/month/lot and would be approximately \$3.00/month/lot if only schedule 1 is awarded.

Again, it is our recommendation that the City award all three phases of the project as we know we have received quality bids from the contractors base on how close they are and feel that should portions of the project be delayed it will only result in higher cost down the road. Please reach out with any questions.

Sincerely,

Great West Engineering, Inc.

A handwritten signature in black ink, appearing to read "Brandon Duffey", is written over a white rectangular area.

**Brandon Duffey, PE
Project Manager**

Encl: Certified Bid Tabs

Y:\Shared\Billings Projects\2-22109 - Red Lodge On-Call 2022\TO 21 - Phase 2 & 3 Stormwater Improvements\Bidding\Red Lodge TO21 - Recommendation to Award.docx

BILLINGS

6780 Trade Center
Avenue
Billings, MT 59101
Ph: (406) 652-5000
F: (406) 248-1363

HELENA

2501 Belt View Drive
Helena, MT 59601
Ph: (406) 449-8627
F: (406) 449-8631

BOISE

3050 N Lakeharbor
Lane
Suite 201
Boise, ID 83703
Ph: (208) 576-6646

GREAT FALLS

702 2nd Street S, #2
Great Falls, MT 59405
Ph: (406) 952-1109

SPOKANE

9221 N Division Street
Suite F
Spokane, WA 99218
Ph: (509) 413-1430

Bid Tabs
City of Red Lodge
Stormwater Improvements Phase 2 and 3
March 14, 2024



ITEM	Quantity	Unit	Engineer's Estimate		Wilson Bros Construction		COP Construction		Western Municipal Construction		JR Civil, LLC	
			Unit Price	Total Price	Unit Price	Total Price	Unit Price	Total Price	Unit Price	Total Price	Unit Price	Total Price
Schedule 1												
100 Mobilization	1	LSM	\$ 81,600.00	\$ 81,600.00	\$ 85,000.00	\$ 85,000.00	\$ 279,350.00	\$ 279,350.00	\$ 246,000.00	\$ 246,000.00	\$ 155,000.00	\$ 155,000.00
101 Traffic Control	1	LSM	\$ 10,000.00	\$ 10,000.00	\$ 12,000.00	\$ 12,000.00	\$ 44,000.00	\$ 44,000.00	\$ 15,500.00	\$ 15,500.00	\$ 86,000.00	\$ 86,000.00
102 Exploratory Excavation	20	HR	\$ 550.00	\$ 11,000.00	\$ 550.00	\$ 11,000.00	\$ 420.00	\$ 8,400.00	\$ 390.00	\$ 7,800.00	\$ 895.00	\$ 17,900.00
103 Imported Backfill	30	CY	\$ 55.00	\$ 1,650.00	\$ 50.00	\$ 1,500.00	\$ 50.00	\$ 1,500.00	\$ 83.00	\$ 2,490.00	\$ 234.00	\$ 7,020.00
104 Water Service Relocation	4	EA	\$ 2,500.00	\$ 10,000.00	\$ 2,500.00	\$ 10,000.00	\$ 2,900.00	\$ 11,600.00	\$ 3,800.00	\$ 15,200.00	\$ 7,713.00	\$ 30,852.00
105 Sanitary Sewer Service	2	EA	\$ 2,000.00	\$ 4,000.00	\$ 4,500.00	\$ 9,000.00	\$ 3,300.00	\$ 6,600.00	\$ 4,900.00	\$ 9,800.00	\$ 7,361.00	\$ 14,722.00
106 18" Diameter Storm Drain	1,175	LF	\$ 115.00	\$ 135,125.00	\$ 115.00	\$ 135,125.00	\$ 130.00	\$ 152,750.00	\$ 87.00	\$ 102,225.00	\$ 162.00	\$ 190,350.00
107 27" Diameter Storm Drain	460	LF	\$ 150.00	\$ 69,000.00	\$ 185.00	\$ 85,100.00	\$ 170.00	\$ 78,200.00	\$ 190.00	\$ 87,400.00	\$ 227.00	\$ 104,420.00
108 48" Diameter Storm Drain	330	LF	\$ 335.00	\$ 110,550.00	\$ 335.00	\$ 110,550.00	\$ 345.00	\$ 113,850.00	\$ 340.00	\$ 112,200.00	\$ 363.00	\$ 119,790.00
109 64" Diameter Storm Sewer Manhole	1	EA	\$ 20,000.00	\$ 20,000.00	\$ 22,500.00	\$ 22,500.00	\$ 15,000.00	\$ 15,000.00	\$ 21,500.00	\$ 21,500.00	\$ 24,250.00	\$ 24,250.00
110 60" Diameter Storm Sewer Manhole	2	EA	\$ 10,000.00	\$ 20,000.00	\$ 9,000.00	\$ 18,000.00	\$ 7,750.00	\$ 15,500.00	\$ 10,700.00	\$ 21,400.00	\$ 13,000.00	\$ 26,000.00
111 48" Diameter Storm Sewer Manhole	6	EA	\$ 8,000.00	\$ 48,000.00	\$ 6,000.00	\$ 36,000.00	\$ 6,800.00	\$ 40,800.00	\$ 8,500.00	\$ 51,000.00	\$ 11,000.00	\$ 66,000.00
112 12" Dia. Storm Sewer	575	LF	\$ 95.00	\$ 54,625.00	\$ 80.00	\$ 46,000.00	\$ 81.00	\$ 46,575.00	\$ 98.01	\$ 56,355.75	\$ 143.00	\$ 82,225.00
113 2x3 Rectangular Box Structure (Curb Inlets)	12	EA	\$ 4,400.00	\$ 52,800.00	\$ 4,500.00	\$ 54,000.00	\$ 4,200.00	\$ 50,400.00	\$ 3,600.00	\$ 43,200.00	\$ 6,340.00	\$ 76,080.00
114 Underground Utility Crossing	19	EA	\$ 750.00	\$ 14,250.00	\$ 350.00	\$ 6,650.00	\$ 1,200.00	\$ 22,800.00	\$ 920.00	\$ 17,480.00	\$ 1,884.00	\$ 35,796.00
115 Remove, Cut and Plug Existing Storm Drain Inlet and Lateral	4	EA	\$ 900.00	\$ 3,600.00	\$ 3,000.00	\$ 12,000.00	\$ 1,200.00	\$ 4,800.00	\$ 1,800.00	\$ 7,200.00	\$ 2,685.00	\$ 10,740.00
116 Cut and Cap Existing Storm Drain	1	EA	\$ 800.00	\$ 800.00	\$ 3,500.00	\$ 3,500.00	\$ 750.00	\$ 750.00	\$ 1,400.00	\$ 1,400.00	\$ 1,790.00	\$ 1,790.00
117 Existing Storm Drain Connection	7	EA	\$ 3,200.00	\$ 22,400.00	\$ 3,500.00	\$ 24,500.00	\$ 2,700.00	\$ 18,900.00	\$ 200.00	\$ 1,400.00	\$ 5,413.00	\$ 37,891.00
118 Connect to Existing Storm Drain Inlet and Tie-into new Storm Main	3	EA	\$ 1,000.00	\$ 3,000.00	\$ 3,250.00	\$ 9,750.00	\$ 1,000.00	\$ 3,000.00	\$ 200.00	\$ 600.00	\$ 3,907.00	\$ 11,721.00
119 MDT Surface Restoration	80	SY	\$ 250.00	\$ 20,000.00	\$ 260.00	\$ 20,800.00	\$ 250.00	\$ 20,000.00	\$ 300.00	\$ 24,000.00	\$ 571.00	\$ 45,680.00
120 Type A Surface Restoration (Asphalt)	2,895	SY	\$ 65.00	\$ 188,175.00	\$ 58.00	\$ 167,910.00	\$ 45.00	\$ 130,275.00	\$ 56.00	\$ 162,120.00	\$ 118.00	\$ 341,610.00
121 Type B Surface Restoration (Aggregate)	65	SY	\$ 30.00	\$ 1,950.00	\$ 35.00	\$ 2,275.00	\$ 4.00	\$ 260.00	\$ 14.00	\$ 910.00	\$ 59.00	\$ 3,835.00
122 Concrete Curb and Gutter	30	LF	\$ 150.00	\$ 4,500.00	\$ 350.00	\$ 10,500.00	\$ 110.00	\$ 3,300.00	\$ 220.00	\$ 6,600.00	\$ 151.00	\$ 4,530.00
123 Concrete Sidewalk, 4" Thickness	20	SY	\$ 275.00	\$ 5,500.00	\$ 350.00	\$ 7,000.00	\$ 225.00	\$ 4,500.00	\$ 510.00	\$ 10,200.00	\$ 281.00	\$ 5,620.00
124 Water Service Replacement	2	EA	\$ 5,000.00	\$ 10,000.00	\$ 4,500.00	\$ 9,000.00	\$ 6,500.00	\$ 13,000.00	\$ 5,800.00	\$ 11,600.00	\$ 8,303.00	\$ 16,606.00
Schedule 1				\$ 902,525.00		\$ 909,660.00		\$ 1,066,110.00		\$ 1,035,580.75		\$ 1,516,428.00
Schedule 2												
200 Mobilization	1	LSM	\$ 133,800.00	\$ 133,800.00	\$ 140,000.00	\$ 140,000.00	\$ 111,696.00	\$ 111,696.00	\$ 165,000.00	\$ 165,000.00	\$ 104,000.00	\$ 104,000.00
201 Traffic Control	1	LSM	\$ 10,000.00	\$ 10,000.00	\$ 7,500.00	\$ 7,500.00	\$ 24,000.00	\$ 24,000.00	\$ 15,100.00	\$ 15,100.00	\$ 75,950.00	\$ 75,950.00
202 Exploratory Excavation	20	HR	\$ 550.00	\$ 11,000.00	\$ 550.00	\$ 11,000.00	\$ 420.00	\$ 8,400.00	\$ 390.00	\$ 7,800.00	\$ 895.00	\$ 17,900.00
203 Imported Backfill	30	CY	\$ 55.00	\$ 1,650.00	\$ 50.00	\$ 1,500.00	\$ 50.00	\$ 1,500.00	\$ 83.00	\$ 2,490.00	\$ 234.00	\$ 7,020.00
204 Water Main Lowering	2	EA	\$ 12,500.00	\$ 25,000.00	\$ 13,000.00	\$ 26,000.00	\$ 12,000.00	\$ 24,000.00	\$ 10,100.00	\$ 20,200.00	\$ 16,475.00	\$ 32,950.00
205 Water Service Relocation	28	EA	\$ 2,500.00	\$ 70,000.00	\$ 2,500.00	\$ 70,000.00	\$ 2,900.00	\$ 81,200.00	\$ 3,800.00	\$ 100,800.00	\$ 7,681.00	\$ 215,068.00
206 Sanitary Sewer Service	2	EA	\$ 2,000.00	\$ 4,000.00	\$ 4,500.00	\$ 9,000.00	\$ 3,300.00	\$ 6,600.00	\$ 4,900.00	\$ 9,800.00	\$ 7,361.00	\$ 14,722.00
207 42" Diameter Storm Drain	2,355	LF	\$ 295.00	\$ 694,725.00	\$ 275.00	\$ 647,625.00	\$ 280.00	\$ 659,400.00	\$ 260.00	\$ 612,300.00	\$ 343.00	\$ 807,765.00
208 96" Diameter Storm Sewer Manhole	1	EA	\$ 35,000.00	\$ 35,000.00	\$ 35,000.00	\$ 35,000.00	\$ 21,000.00	\$ 21,000.00	\$ 25,900.00	\$ 25,900.00	\$ 25,000.00	\$ 25,000.00
209 84" Diameter Storm Sewer Manhole	1	EA	\$ 20,000.00	\$ 20,000.00	\$ 22,500.00	\$ 22,500.00	\$ 15,000.00	\$ 15,000.00	\$ 21,500.00	\$ 21,500.00	\$ 24,263.00	\$ 24,263.00
210 72" Diameter Storm Sewer Manhole	6	EA	\$ 13,000.00	\$ 78,000.00	\$ 14,500.00	\$ 87,000.00	\$ 12,000.00	\$ 72,000.00	\$ 12,200.00	\$ 73,200.00	\$ 18,400.00	\$ 110,400.00
211 12" Dia. Storm Sewer	560	LF	\$ 95.00	\$ 53,200.00	\$ 80.00	\$ 44,800.00	\$ 81.00	\$ 45,360.00	\$ 91.00	\$ 50,960.00	\$ 137.00	\$ 76,720.00
212 2x3 Rectangular Box Structure (Curb Inlets)	16	EA	\$ 4,400.00	\$ 70,400.00	\$ 4,500.00	\$ 72,000.00	\$ 4,200.00	\$ 67,200.00	\$ 3,600.00	\$ 57,600.00	\$ 6,340.00	\$ 101,440.00
213 Underground Utility Crossing	7	EA	\$ 750.00	\$ 5,250.00	\$ 350.00	\$ 2,450.00	\$ 1,200.00	\$ 8,400.00	\$ 920.00	\$ 6,440.00	\$ 1,885.00	\$ 13,195.00
214 Remove, Cut and Plug Existing Storm Drain Inlet and Lateral	4	EA	\$ 900.00	\$ 3,600.00	\$ 3,000.00	\$ 12,000.00	\$ 1,200.00	\$ 4,800.00	\$ 1,800.00	\$ 7,200.00	\$ 2,685.00	\$ 10,740.00
215 Cut and Cap Existing Storm Drain	2	EA	\$ 800.00	\$ 1,600.00	\$ 3,500.00	\$ 7,000.00	\$ 750.00	\$ 1,500.00	\$ 1,400.00	\$ 2,800.00	\$ 1,790.00	\$ 3,580.00
216 Existing Storm Drain Connection	3	EA	\$ 3,200.00	\$ 9,600.00	\$ 3,500.00	\$ 10,500.00	\$ 2,700.00	\$ 8,100.00	\$ 200.00	\$ 600.00	\$ 5,430.00	\$ 16,290.00
217 Type A Surface Restoration (Asphalt)	3,400	SY	\$ 65.00	\$ 221,000.00	\$ 58.00	\$ 197,200.00	\$ 45.00	\$ 153,000.00	\$ 56.00	\$ 190,400.00	\$ 117.00	\$ 397,800.00
218 Type B Surface Restoration (Aggregate)	145	SY	\$ 30.00	\$ 4,350.00	\$ 35.00	\$ 5,075.00	\$ 4.00	\$ 580.00	\$ 11.00	\$ 1,595.00	\$ 59.00	\$ 8,555.00
219 Concrete Curb and Gutter	10	LF	\$ 150.00	\$ 1,500.00	\$ 350.00	\$ 3,500.00	\$ 110.00	\$ 1,100.00	\$ 510.00	\$ 5,100.00	\$ 151.00	\$ 1,510.00
220 Concrete Sidewalk, 4" Thickness	10	SY	\$ 275.00	\$ 2,750.00	\$ 350.00	\$ 3,500.00	\$ 225.00	\$ 2,250.00	\$ 620.00	\$ 6,200.00	\$ 281.00	\$ 2,810.00
221 Water Service Replacement	6	EA	\$ 5,000.00	\$ 30,000.00	\$ 4,500.00	\$ 27,000.00	\$ 6,500.00	\$ 39,000.00	\$ 5,500.00	\$ 33,000.00	\$ 8,257.00	\$ 49,542.00
Schedule 2				\$ 1,488,425.00		\$ 1,442,150.00		\$ 1,356,966.00		\$ 1,415,985.00		\$ 2,117,220.00
Schedule 1 + Schedule 2				\$ 2,388,950.00		\$ 2,351,810.00		\$ 2,423,076.00		\$ 2,451,565.75		\$ 3,633,648.00
Schedule 3												
300 Mobilization	1	LSM	\$ 70,700.00	\$ 70,700.00	\$ 75,000.00	\$ 75,000.00	\$ 66,284.00	\$ 66,284.00	\$ 119,000.00	\$ 119,000.00	\$ 99,000.00	\$ 99,000.00
301 Traffic Control	1	LSM	\$ 10,000.00	\$ 10,000.00	\$ 12,000.00	\$ 12,000.00	\$ 20,000.00	\$ 20,000.00	\$ 15,400.00	\$ 15,400.00	\$ 92,600.00	\$ 92,600.00
302 Exploratory Excavation	20	HR	\$ 550.00	\$ 11,000.00	\$ 550.00	\$ 11,000.00	\$ 420.00	\$ 8,400.00	\$ 390.00	\$ 7,800.00	\$ 895.00	\$ 17,900.00
303 Imported Backfill	30	CY	\$ 55.00	\$ 1,650.00	\$ 50.00	\$ 1,500.00	\$ 50.00	\$ 1,500.00	\$ 83.00	\$ 2,490.00	\$ 234.00	\$ 7,020.00
304 Water Service Relocation	1	EA	\$ 2,500.00	\$ 2,500.00	\$ 2,500.00	\$ 2,500.00	\$ 4,700.00	\$ 4,700.00	\$ 3,700.00	\$ 3,700.00	\$ 7,753.00	\$ 7,753.00
305 Sanitary Sewer Service	5	EA	\$ 2,000.00	\$ 10,000.00	\$ 4,500.00	\$ 22,500.00	\$ 3,300.00	\$ 16,500.00	\$ 4,900.00	\$ 24,500.00	\$ 7,333.00	\$ 36,665.00

Bid Tabs
City of Red Lodge
Stormwater Improvements Phase 2 and 3
March 14, 2024



ITEM	Quantity	Unit	Engineer's Estimate		Wilson Bros Construction		COP Construction		Western Municipal Construction		JR Civil, LLC	
			Unit Price	Total Price	Unit Price	Total Price	Unit Price	Total Price	Unit Price	Total Price	Unit Price	Total Price
306 18" Diameter Storm Drain	725	LF	\$ 115.00	\$ 83,375.00	\$ 115.00	\$ 83,375.00	\$ 130.00	\$ 94,250.00	\$ 87.00	\$ 63,075.00	\$ 162.00	\$ 117,450.00
307 24" Diameter Storm Drain	400	LF	\$ 130.00	\$ 52,000.00	\$ 125.00	\$ 50,000.00	\$ 150.00	\$ 60,000.00	\$ 120.00	\$ 48,000.00	\$ 205.00	\$ 82,000.00
308 27" Diameter Storm Drain	655	LF	\$ 150.00	\$ 98,250.00	\$ 145.00	\$ 94,975.00	\$ 170.00	\$ 111,350.00	\$ 180.00	\$ 117,900.00	\$ 226.00	\$ 148,030.00
309 60" Diameter Storm Sewer Manhole	1	EA	\$ 10,000.00	\$ 10,000.00	\$ 9,000.00	\$ 9,000.00	\$ 7,750.00	\$ 7,750.00	\$ 11,237.25	\$ 11,237.25	\$ 13,000.00	\$ 13,000.00
310 48" Diameter Storm Sewer Manhole	7	EA	\$ 8,000.00	\$ 56,000.00	\$ 6,000.00	\$ 42,000.00	\$ 6,800.00	\$ 47,600.00	\$ 9,400.00	\$ 65,800.00	\$ 11,000.00	\$ 77,000.00
311 12" Dia. Storm Sewer	585	LF	\$ 95.00	\$ 55,575.00	\$ 80.00	\$ 46,800.00	\$ 81.00	\$ 47,385.00	\$ 96.00	\$ 56,160.00	\$ 141.00	\$ 82,485.00
312 2'x3' Rectangular Box Structure (Curb Inlets)	18	EA	\$ 4,400.00	\$ 79,200.00	\$ 4,500.00	\$ 81,000.00	\$ 4,200.00	\$ 75,600.00	\$ 3,600.00	\$ 64,800.00	\$ 6,340.00	\$ 114,120.00
313 Underground Utility Crossing	9	EA	\$ 750.00	\$ 6,750.00	\$ 350.00	\$ 3,150.00	\$ 1,200.00	\$ 10,800.00	\$ 920.00	\$ 8,280.00	\$ 1,884.00	\$ 16,956.00
314 Remove, Cut and Plug Existing Storm Drain Inlet and Lateral	7	EA	\$ 900.00	\$ 6,300.00	\$ 3,000.00	\$ 21,000.00	\$ 1,200.00	\$ 8,400.00	\$ 1,800.00	\$ 12,600.00	\$ 2,685.00	\$ 18,795.00
315 Remove, Cut and Plug Existing Manhole	2	EA	\$ 2,000.00	\$ 4,000.00	\$ 3,500.00	\$ 7,000.00	\$ 2,700.00	\$ 5,400.00	\$ 2,200.00	\$ 4,400.00	\$ 2,685.00	\$ 5,370.00
316 Existing Storm Drain Connection	1	EA	\$ 3,200.00	\$ 3,200.00	\$ 3,500.00	\$ 3,500.00	\$ 2,700.00	\$ 2,700.00	\$ 200.00	\$ 200.00	\$ 5,702.00	\$ 5,702.00
317 Connect to Existing Storm Drain Inlet and Tie-into new Storm Main	8	EA	\$ 1,000.00	\$ 8,000.00	\$ 3,250.00	\$ 26,000.00	\$ 1,000.00	\$ 8,000.00	\$ 200.00	\$ 1,600.00	\$ 4,814.00	\$ 38,512.00
318 MDT Surface Restoration	80	SY	\$ 250.00	\$ 20,000.00	\$ 260.00	\$ 20,800.00	\$ 250.00	\$ 20,000.00	\$ 290.00	\$ 23,200.00	\$ 436.00	\$ 34,880.00
319 Type A Surface Restoration (Asphalt)	2,570	SY	\$ 65.00	\$ 167,050.00	\$ 58.00	\$ 149,060.00	\$ 45.00	\$ 115,650.00	\$ 56.00	\$ 143,920.00	\$ 115.00	\$ 295,550.00
320 Type B Surface Restoration (Aggregate)	45	SY	\$ 30.00	\$ 1,350.00	\$ 35.00	\$ 1,575.00	\$ 4.00	\$ 180.00	\$ 19.00	\$ 855.00	\$ 59.00	\$ 26,786.00
321 Concrete Curb and Gutter	60	LF	\$ 150.00	\$ 9,000.00	\$ 350.00	\$ 21,000.00	\$ 110.00	\$ 6,600.00	\$ 190.00	\$ 11,400.00	\$ 151.00	\$ 9,060.00
322 Concrete Sidewalk, 4" Thickness	35	SY	\$ 275.00	\$ 9,625.00	\$ 350.00	\$ 12,250.00	\$ 225.00	\$ 7,875.00	\$ 510.00	\$ 17,850.00	\$ 281.00	\$ 9,835.00
323 Water Service Replacement	1	EA	\$ 5,000.00	\$ 5,000.00	\$ 4,500.00	\$ 4,500.00	\$ 9,000.00	\$ 9,000.00	\$ 5,500.00	\$ 5,500.00	\$ 8,280.00	\$ 8,280.00
Schedule 3				\$ 780,525.00		\$ 801,485.00		\$ 755,924.00		\$ 829,667.25		\$ 1,364,749.00
TOTAL Estimated Bid Price (Schedules 1+2+3)				\$ 3,169,475.00		\$ 3,153,295.00		\$ 3,108,120.00		\$ 3,261,233.00		\$ 4,998,397.00

Shaded cell represents an error on the Contractor's bid form that has been corrected during tabulations.

I hereby certify that this tabulation of bids is a true representation of the bids received on March 14, 2024.

Brandon W. Duffey, PE



RETURN TO: CITY OF RED LODGE
c/o Dave Westwood
P.O. Box 9
Red Lodge, MT 59068

DECLARATION AND DETERMINATION
BY
CITY OF RED LODGE

DAVE WESTWOOD, Mayor for the City of Red Lodge, Montana, whose address is P.O. Box 9, Red Lodge, Montana 59068, hereby determines, certifies, and declares that the portion of Dailey Ave., located between:

**Lot 5 of Block 45, Red Lodge Original Townsite, lying in Section 27,
Township 7 South, Range 20 East, Principal Montana Meridian,
Carbon County, Montana;**

and Rock Creek, was fully eroded away due to the flood event that happened in June of 2022, as more fully set forth on the attached Exhibit A. Said flood eroded all land located within the boundary area located and described on Exhibit A, such that no remnant of the old landform remained distinct and identifiable before and after said event.

Riparian landowners lose land through the natural process of erosion and gain land through accretion. *Harding v. Savoy*, 100 P.3d 976, 985 (Mont. 2004). Erosion removes all remnants of the former landform, whereas accretion results in a completely new landform. Title to real property does not change if the parcel remains “identifiable” before and after an event. *Mont. Dep’t of State Lands v. Armstrong*, 824 P.2d 255, 257 (Mont. 1992); *McCafferty*, 397 P.2d at 99. Furthermore, if remnants of the old landform are distinct and identifiable before and after the event occurs title remains with the property owner. However, if all land is removed by the erosion event, the landowner loses title and right to said land. *See Jackson v. Burlington N. Inc.*, 667 P.2d 406, 407 (Mont. 1983); *Harding*, 100 P.3d at 985; Mont. Code Ann. § 70-18-206 (2015); *Harding*, 100 P.3d at 985; *McCafferty v. Young*, 397 P.2d 96 (Mont. 1964). *See, e.g., McCafferty*, 397 P.2d 96; *Mont. Dep’t of State Lands*, 824 P.2d 255.

As such, I hereby determine and declare that due to the flooding event that happen in June of 2022, the City of Red Lodge hereby disclaims any right, title, and or ownership of that portion of Dailey Ave. located between Lot 5 of Block 45, Red Lodge Original Townsite, lying in Section 27, Township 7 South, Range 20 East, Principal Montana Meridian, Carbon County, Montana; and Rock Creek, as more fully set forth on the attached Exhibit A.

IN WITNESS WHEREOF, I have caused my name to be subscribed hereunto on this the _____ day of _____, 2024.

DAVE WESTWOOD, Mayor

STATE OF MONTANA)
 : s
COUNTY OF CARBON)

On this _____ day of _____, 2024, before me the undersigned, a Notary Public for the State of Montana, personally appeared DAVE WESTWOOD, known to me to be the person whose name is subscribed to the within instrument and acknowledged to me that he executed the same in his capacity as Mayor for the City of Red Lodge.

IN WITNESS WHEREOF, I have hereunto set my hand and affixed my Notarial Seal the day and year in this Certificate first above written.

Notary Public for the State of Montana

SURVEYOR'S WORKSHEET
LOTS 4 AND 5, BLOCK 45 OF RED LODGE
ORIGINAL TOWNSITE LYING IN SECTION 27, T.7S., R.20E., P.M.M.,
CARBON COUNTY, MONTANA

SURVEYED BY: RED LODGE SURVEYING LLC
DURING 7-25-22
REQUESTED BY: NICK CAMPBELL

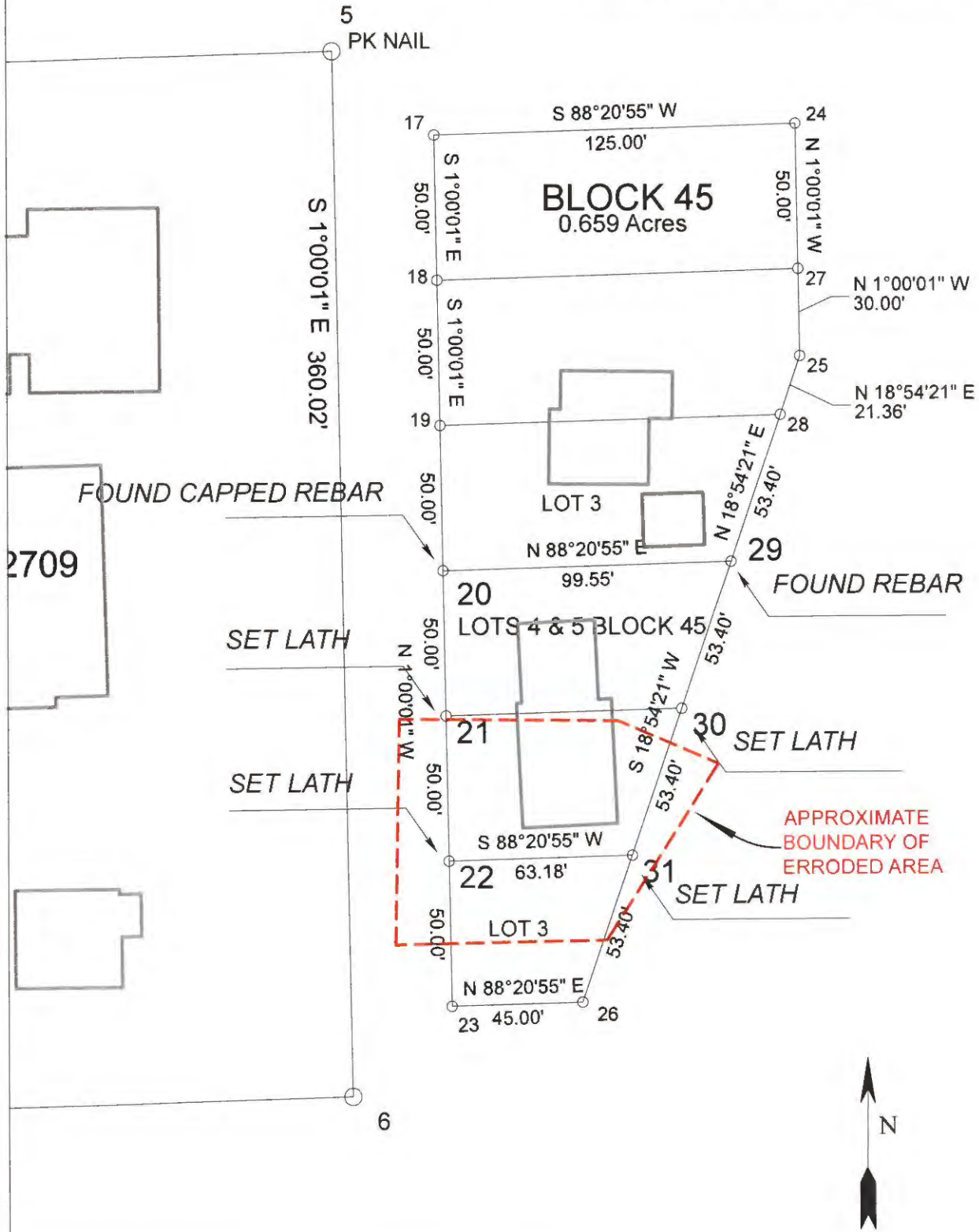

CITY OF RED LODGE

Community Development Department

1 South Platt Avenue

P.O. Box 9

Red Lodge MT, 59068

Telephone: (406) 446-1606 Fax (406) 446-3936

PETITION TO DISCONTINUE STREET OR ALLEY

FEE ATTACHED\$ _____

Pursuant to § 7-14-4114, MCA, the Red Lodge City Council may discontinue a street or alley or any part of a street or alley in the City, if it can be done without detriment to the public interest, upon:

- (a) a petition in writing of all owners of lots on the street or alley; or
- (b) (i) a petition in writing of more than 50% of the owners of lots on the street or alley; and
(ii) approval by a majority vote of the Council.

Before acting upon the petition, a notice must be published, stating when the petition will be acted on and what street or alley or part of a street or alley is asked to be vacated in accordance with the publishing requirements provided in § 7-1-4127, MCA.

Contact Information

Applicant: _____

Address: _____

Telephone: _____

E-mail: _____

Petition Information

Describe the street or alley to be discontinued (attach a vicinity map):

Legal Description of the Right-of-Way to be Discontinued (attach a copy of the Plat showing the street or alley to be discontinued):

Describe how the discontinuation of the street or alley can be accomplished without detriment to the public interest:

Describe any utilities located within the area to be discontinued (the presence of utilities may necessitate approval by the owner of the utility and an easement for the continued protection of the utility lines):

Does the area to be discontinued provide access for mail delivery, trash pickup, trails, parks, or other public or private uses?

Does the area to be discontinued provide access to a water body or stream?

When the street or alley was dedicated to the public, was the right of way taken from property on both sides of the street or alley? Is there any evidence the right-of-way was taken from a property on only one side of the street or alley?

Note that the City Council may adopt conditions to ensure the discontinuation is not detrimental to the public interest. Examples of potential conditions include the installation of pavement, sidewalks, or curb and gutter; the granting of easements for utilities; and setbacks for structures, landscaping, and other improvements. Are there conditions that would be beneficial or necessary to ensure the discontinuation is not detrimental to the public interest?

List the Owners of Property abutting the street or alley to be discontinued and the signatures of those who consent to have the street or alley discontinued (at least 50% of the owners must sign the petition before the City will process the application):

Owner

Signature

Owner

Signature

PASTURE LEASE AGREEMENT

This lease made in duplicate the 13th day of July, 2018 between the **City of Red Lodge**, 1 South Platt, Red Lodge, Montana in the County of Carbon, Montana, hereinafter referred to the "**Landlord**", being the registered owner of the land described below.

And

JIM BUSHNELL and ERIC BOTTORFF

hereinafter referred to as "**Tenants**".

1. **Property**

Witness that in consideration of the rents, covenants, promises and agreements contained in this lease on the part of the tenant to be paid, observed and performed, the Landlord does hereby lease to the Tenant the following farm lands and premises situated in Red Lodge, Carbon County, Montana, that is to say:

(Legal description)

2. **Term**

This lease shall continue in force on said land and premises for and during the term of months from the 1st day of May, 2018 to the 31st day of October, 2018.

Any overholding by the Tenant shall be considered a trespass.

3. **Rent**

a) The Tenant will pay the Landlord the yearly cash rental of \$600.00 per year during the term of this lease agreement for the use of said land during the agreement.

b) Rental fee is to be paid in full on May 1, 2018 and each renewal year thereafter.

4. The terms "Landlord" and "Tenant" shall include their heirs, executors, administrators, successors and assigns in singular or plural number and feminine or masculine gender when the context or the parties so require. All covenants shall be construed as being joint and several.

5. The Tenants shall use the land for pasturing of livestock of which he/she is the owner or to which he/she has the right of possession, and except as herein otherwise provided for no other purpose or purposes whatsoever.
6. The Tenants shall not authorize or permit the land to be used for pasturing of livestock owned by another that is not party to this lease agreement without the written consent of the Landlord. Any consent given shall expire on the last day of the calendar year during which it is given unless the contrary is expressed therein.
7. The Tenants shall cause or permit the any part of the land to be grazed in such a manner that it impairs the normal reproduction of the vegetation.

The Landlord, if it considers the land overgrazed, may by written notice to the Tenants require that the number of livestock be reduced to such numbers and for such periods of time that it considers proper and fit.

8. The Tenants acknowledges and agrees that he/she has no right to sand, gravel or clay and has no rights whatsoever to valuable stone or other such substances existing on or under the surface of the land.
9. The Tenants shall not change the natural course of any waterways on the land or cut down trees growing upon the land. The Tenants shall not allow any other person to cut down trees or change the natural course of the waterways. The Tenants may request of the Landlord to cut down trees or change the natural course of waterways and may do so only in granted permission in writing by the Landlord.
10. If the Tenants fulfills the terms and conditions of this Agreement, he/she shall peaceably possess and enjoy the land for the term of the agreement, without any interruption or disturbance from the Landlord or any representative of the Landlord.
11. The Landlord or it's representative shall have the right at reasonable times to enter onto and inspect the property. The Landlord reserves the right of entry and exit over the land described in Paragraph One (1) of this Agreement to access any land and/or buildings expressly excluded from this Agreement.
12. If either party fails to abide by or perform any provisions of this Agreement, the other may pursue any legal remedy available.
13. Taxes: Unless otherwise agreed, the Landlord shall be responsible for the payment of any and all land taxes.
14. Improvements and Seeding: The Tenants shall not make improvements to the land other than what is considered normal repair and maintenance to the leased land without written permission from the Landlord. No major improvements are allowed without written permission of the Landlord. Major improvements include but is not limited to water development, erosion control, fencing, building construction, clearing, breaking and

seeding to pasture and hay land. Such consent shall be attached to and form part of this lease agreement.

15. Repair and Maintenance of Fences:

The Tenants agree to be responsible for and maintain fences.

16. Insurance:

The Tenants is free to make his/her own arrangements regarding livestock insurance at his/her own expense.

17. Subletting:

The Tenants shall not sublet or assign this lease or any part thereof without prior written consent of the Landlord.

18. Renewal:

This lease shall renew each year on May 1st.

19. Default In Payment:

When the Tenants does not make payment of the rental in accordance with the terms and conditions of this lease agreement, the current year's rental and any further payments owing for that year shall become due and payable immediately, and the Landlord may repossess and enjoy the land as if this Agreement had not been executed.

20. Utilities, Roads and Rights-of-Way:

In the event that a new installation of a road, power line, pipeline or railway is constructed upon the land, the Landlord and Tenants may renegotiate the terms of this Agreement if the construction affects the Tenants use of the property.

21. Termination:

The Landlord and Tenants may terminate this lease at any time by mutual agreement. The Landlord shall give the Tenants thirty (30) days written notice should the Landlord wish to termination the Lease. Likewise, the Tenants shall give the Landlord thirty (30) days written notice should they desire to terminate the lease.

We, Jim Bushell and Eric Bottorff, do hereby accept the terms of this Lease Agreement to be held by us as Tenants, and subject to the conditions, restrictions and covenants above set forth.

In Witness Whereof, the Parties have set their hand and seals on this the 13th day of July, 2018.

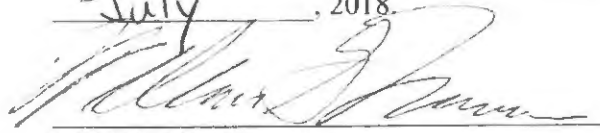

LANDLORD

BY: Mayor of Red Lodge



WITNESS

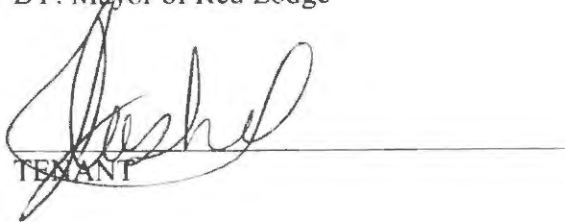

TENANT



WITNESS

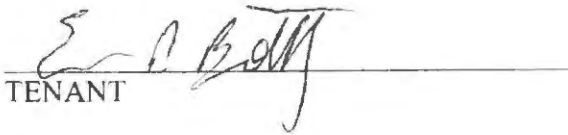

TENANT

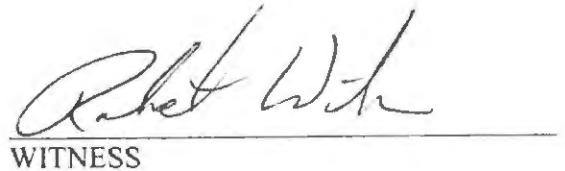

WITNESS

RESOLUTION NO. 3648

A RESOLUTION BY THE CITY COUNCIL OF THE CITY OF RED LODGE, MONTANA, AUTHORIZING THE CITY TO ENTER INTO AN AGREEMENT WITH THE ALL NATIONS GARDEN CLUB OF RED LODGE FOR THE CARE AND MAINTENANCE OF PRIDE PARK, A CITY OWNED PROPERTY.

Whereas, the All Nations Garden Club has generously offered to assume some of the care and maintenance of Pride Park; AND

Whereas, the City has encouraged civic organizations to be involved with parks; AND

Whereas, it is in the City of Red Lodge's interests and goals to provide clean, well-kept park facilities; AND

Whereas, a memorandum of understanding (MOU) between the City of Red Lodge and the All Nations Garden Club was executed on February 9, 2023, but without the direction of Council;

NOW THEREFORE BE IT RESOLVED the City Council directs the Mayor to finalize this MOU Agreement and take necessary actions as needed to implement it.

PASSED AND APPROVED BY A MAJORITY OF THE RED LODGE CITY COUNCIL on this 23rd Day of April, 2024.

For the City of Red Lodge, Montana:

Dave Westwood, Mayor

Attest:

Loni Hanson, City Clerk

**MEMORANDUM OF UNDERSTANDING
BETWEEN
THE CITY OF RED LODGE
AND
ALL NATIONS GARDEN CLUB**

On this 9th day of February, 2023, this Memorandum Of Understanding ("MOU") is made and entered into by and between the City of Red Lodge, a municipal corporation organized and existing under the laws of the State of Montana whose address is P.O. Box 9, Red Lodge, Montana 59068, hereinafter referred to as "City" and the All Nations Garden Club, whose address is P.O. Box 237, Red Lodge, MT 59068, hereinafter referred to as "Garden Club".

WITNESSETH

WHEREAS, an MOU between the City and the Garden Club does not currently exist for the purpose of the design, development, maintenance, and administration of Pride Park, and

WHEREAS, it is the intention of the City and the Garden Club to establish an MOU to maintain the park area owned by the City and defined as Pride Park, and

WHEREAS, the Parties have discussed the contents of this MOU and acknowledge that they understand their respective duties and obligations and that each party intends to perform their respective duties and obligations as agreed hereunder, and

WHEREAS, Pride Park is located in the City and is generally described as located at the northwestern intersection of Broadway Avenue South and 12th Street, and

WHEREAS, both Parties agree that the continued existence and operation of Pride Park is in the best interest of the public, and

WHEREAS, to further Pride Park's existence and availability to the public, the Parties agree to enter into this MOU, to provide landscape maintenance services and necessities for Pride Park.

NOW, THEREFORE, in light of and furtherance of the matters set forth in the above recitals, the City and the Garden Club agree as follows:

The Garden Club Shall:

1. Assist in maintaining the landscaping in the Park from April 15th to October 15th.
2. Provide grass mowing, weed eating and light bush and tree pruning. Light pruning is defined as that performed using non-motorized or small-motorized hand tools, without ladders or structural support.

3. Maintain mowers and other equipment including the provision of gas, oil and other supplies. Pay for expenses up to \$500 and provide documentation of these and additional maintenance expenses in excess of \$500 to the Community Development Department
4. Set the schedule and program the sprinkler system for irrigation of the Park.
5. Coordinate maintenance and repairs of the irrigation system with the City's designated contractor and the Community Development Department.
6. Maintain and water flower beds, including the purchase of planting materials.
7. Notify the City of club-related fundraising activities and events in the park. Requests for events not affiliated with the Garden Club in the Park shall be forwarded to the Community Development Department.
8. Indemnify, save and hold the City harmless against all claims, costs, expenses, damages and liabilities that may arise from the use of the City's storage facilities.

The City Shall:

1. Pay for appropriate maintenance expenses in excess of \$500 per year and provide replacement mowing and landscaping equipment, per coordination with the Community Development Department.
2. Pay for irrigation maintenance and repairs per coordination with the City's designated contractor and the Community Development Department.
3. Regularly maintain waste bins
4. Pay for sign construction.
5. Maintain current liability coverage through the Montana Municipal Interlocal Authority in order that the volunteers for the All Nations Garden Club are a Covered Party.
6. Provide funding for improvements to Pride Park, if available, through recommendation to the Red Lodge Parks, Trees and Recreation Board, the Mayor and the City Council.

General Provisions:

1. The term of this MOU is for five years commencing on the date of approval by both Parties. The Parties may extend this MOU by a duly approved and signed written agreement.
2. Either Party may terminate this MOU, with or without cause, without liability or damages, by written notice given at least 30 days prior to the effective date of termination to the other Party.

3. This MOU is not intended to create any authority, partnership, venture, employment, fiduciary, trust or agency relationship between the Parties. Each Party shall be an independent contractor of the other Party. No Party may bind another Party without the other Party's written permission and consent.
4. This MOU shall not preclude a Party from entering third-party agreements/relationships that do not conflict with this MOU.
5. Nothing in this MOU is intended to, nor shall this MOU transfer or grant any property interest, franchise, license, right, permission or approval except as expressly provided herein.
6. Each Party shall bear its own costs and expenses in pursuit of its duties, responsibilities and obligations herein except to any extent expressly provided herein.
7. The Parties' representatives for the purposes of this MOU and notice hereunder are as follows or as designated by a Party to the other Party in writing from time-to-time:

CITY OF RED LODGE:
Attn: Red Lodge Mayor
P.O. Box 9
Red Lodge, MT 59068

ALL NATIONS GARDEN CLUB
Attn: President
P.O. Box 237
Red Lodge, MT 59068

8. The Parties acknowledge that this MOU in its final form is the result of the combined efforts of the Parties. Should any provision of this MOU be found to be ambiguous in any way, such ambiguity shall not be resolved by construing this MOU in favor or against any Party, but rather by construing the terms in accordance with their generally accepted meaning.
9. Modifications or amendments to this MOU must be duly approved by each Party in writing signed by an authorized agent of each Party.
10. Each Party agrees to use best efforts in pursuit of this MOU, and shall at all times comply with all applicable federal, state and local laws, regulations and requirements now in force and as they may be enacted, issued, or amended during the term of this MOU for any acts taken hereunder.
11. This MOU constitutes the entire Agreement between the Parties with respect to the subject matter hereof and supersedes all previous agreements, negotiations, proposals, commitments, writings, advertisements, publications, and understandings of any nature whatsoever unless expressly included in this MOU.
12. The Parties agree that the laws of the State of Montana govern this MOU. The Parties agree that the venue is proper within the courts of Carbon County, Montana. If a dispute arises, the

Parties, through a representative(s) with full authority to settle a dispute, shall meet and attempt to negotiate a resolution of the dispute in good faith no later than ten business days after the dispute arises. If negotiations fail, the Parties may use a third party mediator and equally share the costs of the mediator or file suit.

13. If any action is filed in relation to this MOU, the unsuccessful party in the action shall pay to the successful party, in addition to all sums that either is ordered to pay, a reasonable sum for the successful party's attorney's fees and all costs, charges, and expenses related to the action.
14. The Parties recognize that Title 8, Chapter 7 of the Red Lodge City Code provides policies intended to establish, improve, care for, regulate and manage a system of public recreation and public trees under the authority of the Red Lodge Parks, Trees and Recreation Board that may impact the provisions of this MOU.

IN WITNESS WHEREOF, the Parties hereto have executed this MOU as of the day and year first herein above written:

Kristen Cogswell
Kristen Cogswell, Mayor,

Witness [Signature]

Monica J. Boggio
Notary Public

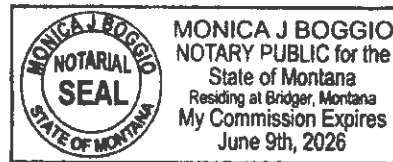

Terri Kellcher
President, All Nations Club

Witness Katherine C. Bursley

Monica J. Boggio
Notary Public

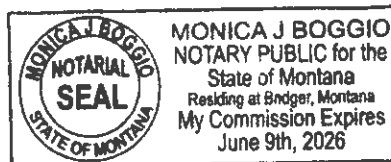



a Day of
**COMMUNITY
SERVICE**

Building Unity through Community Service

For Individuals:

- **SIGN-UP**
at JustServe.org
- **SERVE**
in a project
- **SHARE**
the experience

Volunteers include:
individuals, families,
service clubs,
faith organizations,
your neighbors,
youth and
student groups...

Saturday April 27, 2024
9:00am-12:00pm



 **JUSTSERVE.org**



About JUSTSERVE

JustServe.org is a website where the volunteer needs of organizations are posted, and volunteers search for opportunities to enhance the quality of life in the community.

JustServe is a free service that links community volunteer needs with volunteers and does not discriminate based on race, religion, gender, ethnicity, or sexual orientation in posting projects or in encouraging volunteers to serve according to our guidelines.

1

Find a Project

Discover a local service opportunity based on your interests.

2

Invite Friends

Ask friends to serve with you through a simple invite.

3

Help Out

Serve at the project with friends and community members.

4

Connect w/ Community

Build lasting connections and unity in the community.

Sign Up Today!

Sign up today to start making a difference in the community. You'll get email notifications when new projects are posted in your area.

HOW
DO I
SIGN
UP?

1. Visit JustServe.org
2. Select "sign in/register"
3. Sign in on "Register Now" and confirm email
5. Apply search filters with city, state or zip
6. Choose your desired project & select "Volunteer"

Why Volunteer?

- We may not solve world hunger immediately, but we're convinced that by serving with each other in our local communities, we're paving the way for much broader changes. Our individual efforts don't need to be huge—a little bit of change here, a few hours there—but even small efforts quickly add up to make a real difference.
- As we work side-by-side and learn from each other, mutual understanding increases, misconceptions can be corrected, and new friendships are built.

Community Guidelines

- The best service opportunities are collaborative—working side by side with others in faith-based, nonprofit, community, and government organizations.
- Community service opportunities should enhance the quality of life in the community and assist the poor and those in need.
- JustServe projects should not have a political or other advocacy focus, be for-profit oriented, or directly involve volunteers in soliciting or handling money or other prohibited activities.

JOIN THE MOVEMENT
VOLUNTEER WITH  JUSTSERVE



A Gift to Communities

When your faith, nonprofit, community, or governmental organization is looking for meaningful ways to involve employees or members in service to the community, there is no need to look further than JustServe.org, a free community resource.

The JustServe.org website is used by organizations to post service opportunities and publicize their needs. Volunteers can search for service opportunities that meet their interests, skills, and availability.

JustServe.org reduces the time needed for volunteers to find meaningful service opportunities and allows more time to give service. It helps your organization get involved in the community and allows employees or group members to select service opportunities that are a perfect fit for themselves, their family, or your organization.

How to sign up

1. Visit JustServe.org or the JustServe app.
2. Select "Sign in/Register" and create an account, or register with your Facebook account.
3. Confirm your registration by responding to an email sent from JustServe.org.

How to serve

1. Visit JustServe.org or the JustServe app.
2. Search for a project by location, or apply advanced search filters.
3. Volunteer for your desired project.

How to submit service projects

Visit JustServe.org, select "Submit a Project," and provide the necessary information. The proposed project will be reviewed and, following approval, posted on the website.

VISIT JUSTSERVE.ORG OR DOWNLOAD THE APP TODAY!

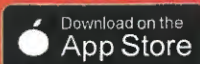

JustServe.org is provided as a service by The Church of Jesus Christ of Latter-day Saints.

© 2019 by Intellectual Reserve, Inc. All rights reserved. PD60007149



Connecting volunteers with opportunities to care for others and improve our communities.



Become a JustServe Administrator

Register on [JustServe.org](https://www.justserve.org). There are no fees or obligations to participate. You can begin by submitting a project through [JustServe.org](https://www.justserve.org) for local approval, or ask your JustServe representative how to become a project administrator for your faith, nonprofit, community, or governmental organization.

Contact your local JustServe representative or visit [JustServe.org](https://www.justserve.org) for more information.

VISIT [JUSTSERVE.ORG](https://www.justserve.org) OR DOWNLOAD THE APP TODAY!



JustServe.org is provided as a service by The Church of Jesus Christ of Latter-day Saints. © 2019 by Intellectual Reserve, Inc. All rights reserved. PD19053894



Serve in Your Community

Faith, nonprofit, community, and governmental organizations around the country are discovering how JustServe can bring communities together by making volunteer opportunities easy to find and fun to participate in.

Volunteers include individuals, families, service clubs, faith organizations, and youth and student groups.

How It Works



JustServe's Combined Approach

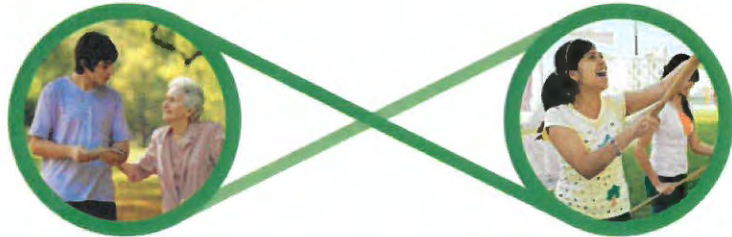

JustServe works with organizations to make opportunities visible to the volunteer network. Find a project, sign up within minutes, and help care for others and build your community, with no fees or obligations.

Projects Include:

- | | |
|-------------------------|----------------------------|
| Blood Drives | River and Coastal Cleanups |
| Shelters | Schools and Libraries |
| Soup Kitchens | Park Beautification |
| Food Banks and Pantries | Senior Centers |
| Faith Groups | Community Gardens |
| Disaster Relief | Tutoring |

Improving Communities

JustServe is a great way to promote volunteerism and connect people in faith, nonprofit, community, and governmental organizations with volunteers.

Building Volunteers

It's an easy way for volunteers to search for opportunities that resonate with their interests. Through their efforts, they develop a sense of unity, collaboration, and friendship with others.